



WALRUS®

PW-A Series Submersible Pump

ISO 9001

Coverage of Application

1. To be used to circulate water in garden ponds
2. To be applicable to the sprinkler for vegetations of parks.
3. Watering in the garden and washing car.
4. To drain the accumulated water for basement of residence.
5. To drain the ground water.
6. To drain accumulated water for civil and architecture engineering.
7. The "R" type available to used in sea fish breeding.
8. The "C" type equipped level regulator.
9. The "D" type low suction capability up to 3 mm

Performance Curve

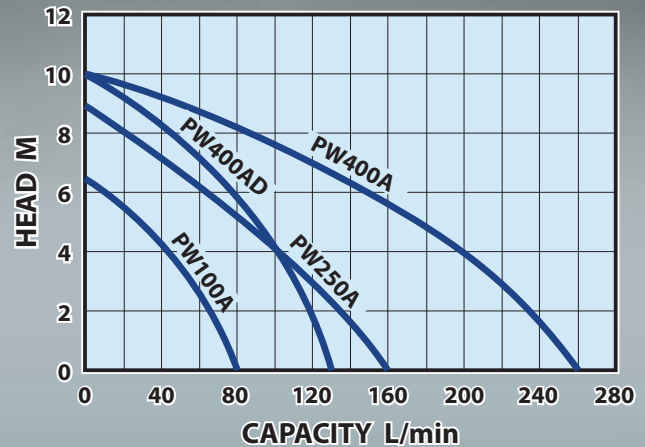

Characteristic

1. Submersible pumps for clean water.
2. Corrosion-resistant and compact.
3. Built-in capacitor.
4. Supplied with power cable with plug
5. Motor with thermo overload protection

Specifications

Power supply: single-phase 50 or 60 Hz

Power: 100W to 400W

Insulation class: B

Protection: IP68

Length of cable: 4 or 5 m

10 m (Optional)

Delivery: up to 260 L/min

Head: up to 10 m

Temperature of pumped liquid: 4°C to +35°C



WALRUS PUMP

Sectional drawing

PW100A

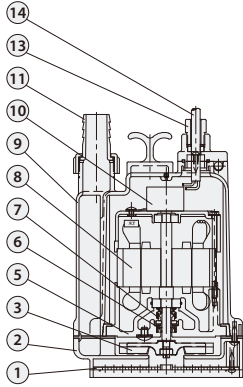

PW250A

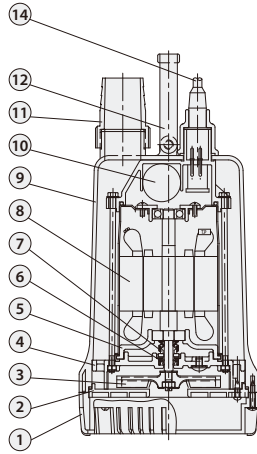

PW400A

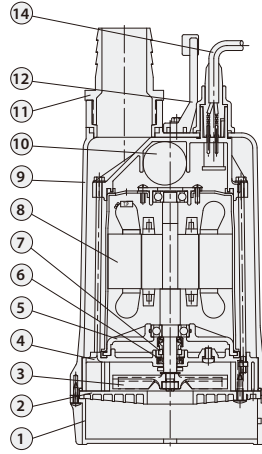

PW400AD

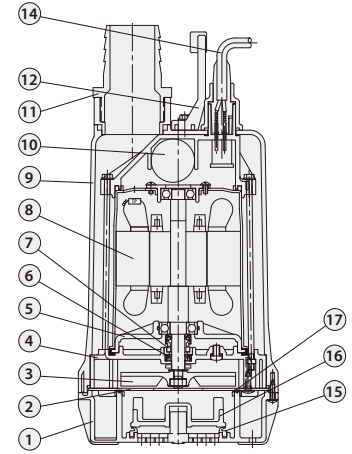

Part list

No.	Description	No.	Description
1	Strainer	10	Capacitor
2	Suction Cover	11	Outlet
3	Impeller	12	Handle
4	Current Conduction	13	Cable Fixed Cap
5	Flange Bracket	14	Cable Wire
6	Oil Seal	15	Gasket
7	Mechanical Seal	16	Check Valve Plug
8	Motor	17	Gasket
9	Pump Shell	18	

Level regulator

(PW100AC / PW100ARC)



Specifications

Type	Outlet Diameter In. (mm)	Output W	Cycle Hz	Volt V	Amp's A	Maximum		Dimensions L x W x H mm	Cable Wire C x mm ² x m	N.W. kg	G.W. kg	
						Head m	Capacity L/min					
PW100A	1" (25)	100	50	220 - 240	1.0	6.5	80	155 x 140 x 241	3 x 0.75 x 4	4.0	4.6	72
			60	110 220	2.0 1.0							
PW250A	1½" (32)	250	50	220 - 240	2.0	9.0	160	164 x 164 x 350	3 x 1.25 x 5	5.1	5.5	72
			60	110 220	4.0 2.0							
PW400A	2" (50)	400	50	220 - 240	3.5	10	260	183 x 183 x 382	3 x 1.25 x 5	7.9	8.3	50
			60	110 220	7.0 3.5							

Sea water pump

PW100AR	1" (25)	100	50	220 - 240	1.0	6.5	80	155 x 140 x 241	3 x 0.75 x 4	4.1	4.7	72
			60	110 220	2.0 1.0							
PW400AR	2" (50)	400	50	220 - 240	3.5	10	260	183 x 183 x 382	3 x 1.25 x 5	7.9	8.3	50
			60	110 220	7.0 3.5							

Pump with level regulator

PW100AC PW100ARC	1" (25)	100	50	220 - 240	1.0	6.5	80	220 x 140 x 241	3 x 0.75 x 4	4.5	5.0	48
			60	110 220	2.0 1.0					4.6	5.1	

Low Suction Pump (Drainage to 3 mm from floor)

PW400AD	2" (50)	400	50	220 - 240	3.5	10	130	183 x 183 x 384	3 x 1.25 x 5	8.4	8.8	50
			60	110 220	7.0 3.5							